

MICHIGAN HEALTH SCIENCES
LIBRARIES ASSOCIATION

22nd Annual Educational Conference
1995

*Northern Exposure. . .
Emerging Roles in
Information Management*



September 27-29, 1995
Park Place Hotel
Traverse City, Michigan

CONTRIBUTORS

MHSLA would like to thank the following for their support:

Binding Unlimited, Inc.
The Faxon Company
Readmore, Inc.
Rittenhouse Book Distributors, Inc.

EXHIBITORS

Ebsco Subscription Services
The Faxon Company
Fennell Subscription Service
Login Brothers Book Company
Matthews Medical & Scientific Book Co., Inc.
The Network for Continuing Medical Education
Rittenhouse Book Distributors, Inc.
W.B. Saunders Company, Bob Van Every

EXHIBIT AREA HOURS

Thursday, September 28
8:30 - 2:00 p.m.
Dome

WEDNESDAY, SEPTEMBER 27

8 a.m. - 5 p.m.

Continuing Education

(Lunch, Top of the Park, 12-1 p.m.)

**CE 501 (MLA)
Torch**

Research Methods for Health Sciences Librarians

This course covers research methods, statistical analysis and practical applications of library research for health sciences librarians.

Instructor: Joanne G. Marshall

University of Toronto, Faculty of Information Studies,
Toronto, ON, Canada

**NP 512
Leelanau**

Developing the Hospital's Information Management Plan

In this course you will examine the 1996 JCAHO Standards for the management of information and devise strategies to meet the Standards. Emphasis will be on developing a hospital-wide information needs assessment and a plan to meet JCAHO accreditation standards.

Instructor: Christiane Jones

Library Services, Department of Veteran Affairs Medical
Center, Biloxi, MS

6 - 8:30 p.m.

Malabar Sunset Cruise

(Preregistration required)

Meet at Conference Registration Desk no later than 5:10 p.m. to carpool. Check-in at 5:30 p.m. at Tall Ships' Office on West Bay. Dress for the conditions as it will be cooler on the water.

6 p.m.
Courtyard 1-2

MHSLA Board Meeting and Dinner

THURSDAY, SEPTEMBER 28

8:30 - 9:30 a.m.
Dome

Exhibit Opening & Breakfast Buffet

9:30 a.m.
Dome

Opening Session

9:45 - 10:30 a.m.
Dome

Keynote Address - "Planning for 2000. . . Trends Affecting Libraries and Librarians in the 21st Century"
Speaker: Joanne Marshall

10:30 - 11 a.m.

Break in the Exhibit Area

11 - 12:30 p.m.
Dome

MHSLA Business Meeting

12:30 - 2 p.m.

Luncheon Buffet, Exhibit Area

12:30 - 2 p.m.
Top of the Park

MACHIS Luncheon Meeting
(Preregistration required)

2 - 5 p.m.

Workshops
(Break at 3:30 p.m.)

Torch

Internet Navigational Tools
Julie Herrin, Michigan Library Consortium, Lansing, MI

This course focuses on the tools available for searching the Internet and World Wide Web and how to use them to navigate through the Internet.

An online demonstration will feature Gopher software, Mosaic, Netscape and Veronica searches.

Leelanau

Training the Trainer
Charlaine Ezell, President, The Extra Edge, Lansing, MI

A workshop for instructors who must deliver skill-based training to small groups. Topics include: how adults learn, designing and planning a training program, motivating learners, evaluating training, effective communication and presentation techniques and creative ways to reinforce training.

5:30 p.m.

Special Event & Dinner
(Meet in the Hotel Lobby to board buses for a fun, food-filled evening. Dress - casual, but nice!)

6 - 7 p.m.

Wine-tasting and tour of Chateau Grand Traverse.

7 - 9 p.m.

Dinner on Old Mission Peninsula at Bowers Harbor Inn.

FRIDAY, SEPTEMBER 29

7:30 - 8:30 a.m.
Court Yard 1

MSU Library Affiliates' Breakfast

Host: Craig Mulder
(Preregistration required)

8:30 - 9:30 a.m.
Top of the Park

Poster Session & Continental Breakfast

- 1) "A Medical Library in Your Mailbox"
Margaret Connors, Chelsea Community Hospital, Chelsea
- 2) "Internet. . . Practical Use in a Physician's Office"
Connie Bongiorno, Oakwood Hospital, Dearborn
- 3) "Medical Library Journal Survey"
Alexia Estabrook & Carole Gilbert, Providence Hospital,
Southfield
- 4) MSHLA Archives
Bill Nelton, Michigan Department of Mental Health, Lansing
- 5) "Library Business Plans"
Doris Blauet, Genesys Regional Medical Center - Flint
Osteopathic; Ria Lukes, Genesys - St. Joseph Campus;
Martha Studaker, Hurley Medical Center, Flint
- 6) "MGH Health Information Center"
Linda Winslow, Marquette General Hospital, Marquette
- 7) "Information Management and Bibliographic Software"
Maureen Watson, Ferris State University, Big Rapids
- 8) "Consumer Health/Patient Education Survey Report"
Barbara Platts, Wm. Beaumont Hospital, Troy;
Beth Salzwedel, Bon Secours Hospital, Grosse Pointe
- 9) "MSHLA Conference. . . 1996"
Leslie Behm & Deborah Jankowski, Michigan State
University, East Lansing

11 - 12:30 p.m.

Lunch on your own. . . and Power Shopping!

12:30 - 4:30 p.m.

Workshops

(Break at 2:30 p.m.)

Leelanau

**Needs Assessment and Survey Techniques
(3.5 MLA Contact Hours)**

Leslie M. Behm, Michigan State University

A workshop designed to help the librarian who wants to do a needs assessment or other type of survey. Included are: development of questionnaires, how to test the instrument and how to tabulate and interpret the results.

Torch

Basic Automation

Moderator: Peggy Zorn, Parke-Davis, Ann Arbor

**Panel: Judy Barnes, Michigan Capital Medical Center -
Penn Campus, Lansing**

Joan Emahiser, Wm. Beaumont Hospital, Royal Oak

Marge Kars, Bronson Methodist Hospital, Kalamazoo

Ellen O'Donnell, St. John Hospital, Detroit

*Please turn in your Conference Evaluations at your last workshop
or MHSLA Registration Area.*

PARK PLACE HOTEL

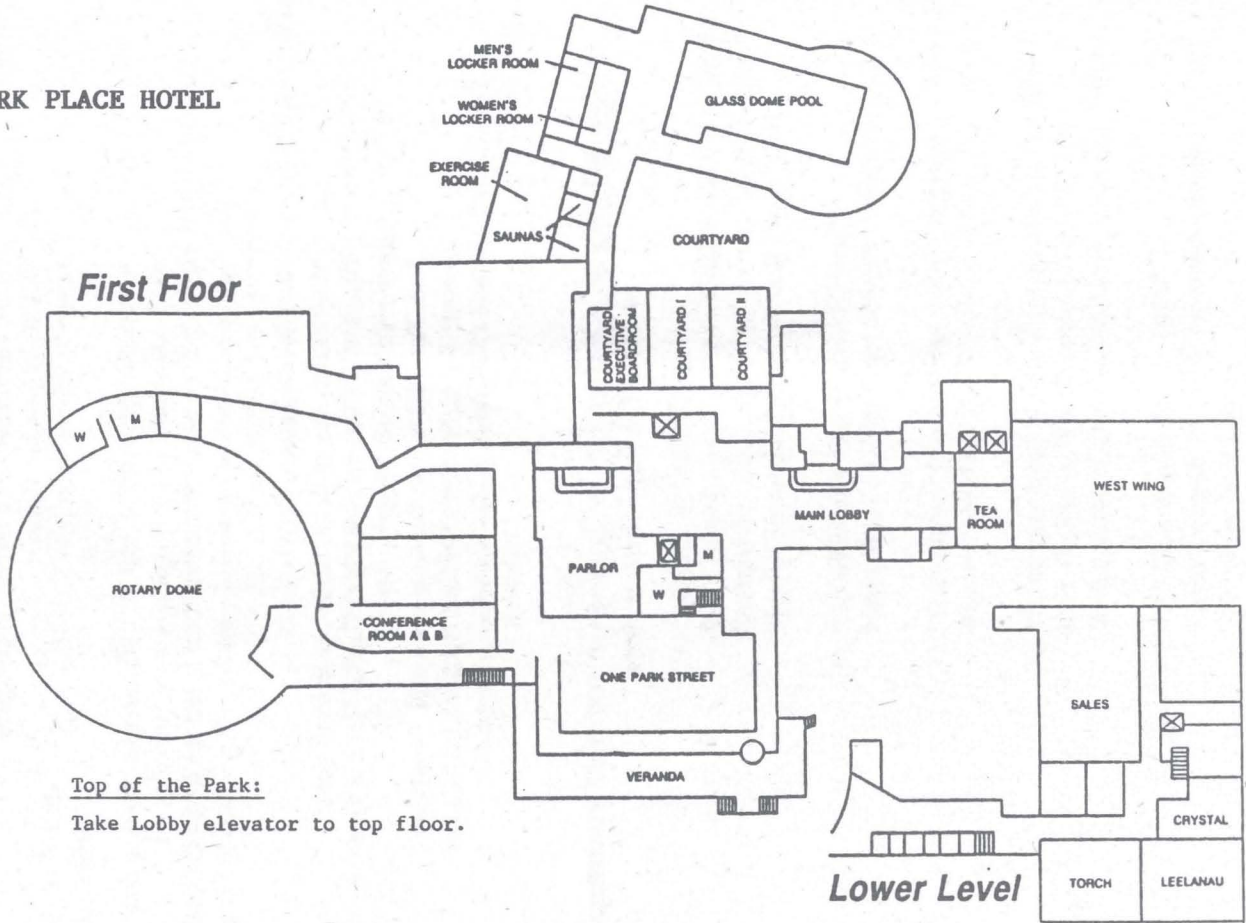

Top of the Park:
Take Lobby elevator to top floor.

Lower Level